

LIFT-ASSIST DAMPER **LAD-ST** With Stopper

L=R

INSTRUCTION



Lift-assist

Soft-close

Passed 100,000 open/
close private cycle test

[Application Example]

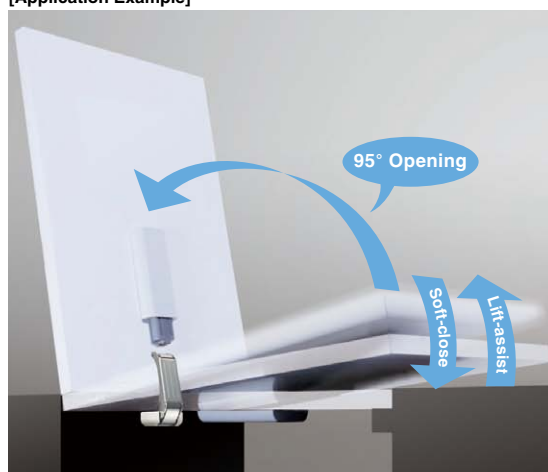

Opening Direction	Item Name	Description	Non-handed	Maximum Door Moment
 Top-opening	LAD-ST-L	Lift-assist	Yes	8.0~10.5 N · m/pc (81.6~107.1 kgf · cm/pc)
	LAD-ST-M	Soft-close		10.5~13.5 N · m/pc (107.1~137.7 kgf · cm/pc)
	LAD-ST-H			13.5~16.0 N · m/pc (137.7~163.2 kgf · cm/pc)

- Ideal for counter flaps at bars, restaurants, and receptions.
- Smooth and soft close movement at the end, preventing flaps from slamming shut. Damper works even at a slight opening angle.
- Lift-assist mechanism with light opening.
- Stops flap at 95° opening with stopper.
- Suitable for door thickness 15~40mm.
- Can be post-installed to existing counters without processing.
- Installation position can be easily determined with the supplied template.

[Specifications]

- Operating temperature: 0°C~40°C

[Remarks]

- Simply holds rather than fixes flap in opened position.
- Make sure to have sufficient hinge strength and installation strength at door hanging side.
- Do not use concealed hinge.
- Closed flap cannot be held with only this product. Please install a catch at the front end of flap.
- Do not forcibly open and close flap more than necessary.
- Ensure that the distance from mounting surface of damper unit and stopper to flap surface is 15~40mm (see drawing).
- Be careful not to pinch fingers between arm unit and damper unit.
- Do not use with spacer LAD-DP **1** (for thick door) and bracket for back mount LAD-BKT **2** (for horizontal installation).

Selection Tool
Sasuga-kun
Applicable Products
Used for Product
Selection &
Simulation.
Available on Web!

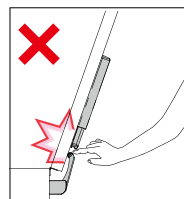

[Parts Included]

- Binding head tapping screw 4×16
- Template for positioning

● Soft-close

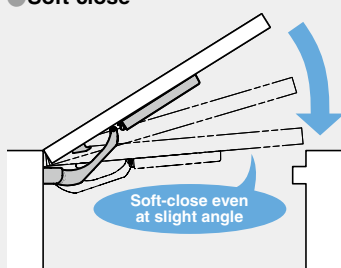

Damper works just before flap closes, preventing it from slamming shut and pinching fingers.

Soft-close even at slight angle

● With stopper

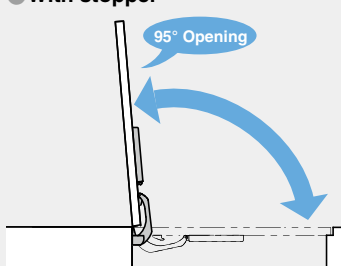

Stops flap at 95° opening.

● Lift-assist

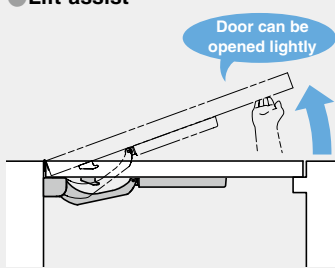

Lift-assist mechanism with light opening.

● Easy post-installation

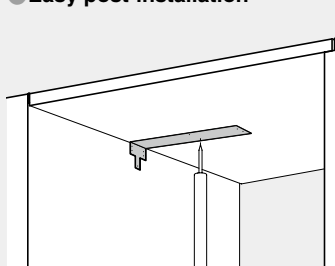

Can be post-installed to existing counters without processing. Simply by pressing against the supplied mounting template, installation position can be easily determined.

Refer to **1** **2** : P.233



SOFT
CLOSING
STAYS

TORQUE STAYS

HEAVY DUTY
LOCKING
STAYS

FOOT
STAYS

LID
STAYS

OTHER STAYS

TOP-
OPENING

DOWNWARD-
OPENING

UPWARD-
OPENING

BOTTOM-
OPENING

SWING
DOOR

LIFT-UP

LIFT-
DOWN

UP &
OVER

BI-
FOLDING

OVER
THE
TOP

$$= \text{Door weight (kg)} \times 9.80665 \times \text{Distance from rotation centre to door centre of gravity (m)}$$